



# Town of Griswold Building Department

APPLICATION FOR BUILDING PERMIT / CERTIFICATE OF ZONING COMPLIANCE  
SINGLE FAMILY, MULTI-FAMILY, COMMERCIAL, INDUSTRIAL STRUCTURES



**\*\*\*THIS PERMIT MUST BE COMPLETED IN FULL\*\*\***

This application for permit is made pursuant to the 2015 State of Connecticut IRC Section R105/IBC Section 105/ 2018 Connecticut State Building Code and is to be used for all construction requiring a permit under said code. **THIS IS NOT A BUILDING PERMIT.** Any permit granted pursuant to this application will be valid for only the type of work noted on this application. Detailed plans and specifications must be submitted for all construction as determined by this office.

**1. STREET ADDRESS:**

\_\_\_\_\_

Check One: Town \_\_\_\_\_ Borough \_\_\_\_\_

Assessors Map/Block/Lot #: \_\_\_\_\_

Zoning District: \_\_\_\_\_

If subdivision:

Name of Subdivision: \_\_\_\_\_

Lot # \_\_\_\_\_ Section \_\_\_\_\_

**5. USE OF PROPOSED STRUCTURE: (check one and list type)**

Single Family Residence (ex:cape,ranch,colonial) \_\_\_\_\_

Multi-Family Dwelling \_\_\_\_\_

Commercial \_\_\_\_\_

Addition \_\_\_\_\_ Industrial \_\_\_\_\_

Other (include decks,porches,etc.): \_\_\_\_\_

**2. OWNER:**

Name: \_\_\_\_\_

Mailing Address: \_\_\_\_\_

Contact Phone(s): \_\_\_\_\_

**6. STRUCTURE DIMENSIONS:**

(do not include garage)

Overall Length \_\_\_\_\_

Overall Width \_\_\_\_\_

Overall Height \_\_\_\_\_

Number of Stories \_\_\_\_\_

1<sup>st</sup> Floor Area \_\_\_\_\_ sqft

2<sup>nd</sup> Floor Area \_\_\_\_\_ sqft

Total Floor Area \_\_\_\_\_ sqft

Lot Area: \_\_\_\_\_ sq ft./acres

**7. GARAGE:**

Dimensions: \_\_\_\_\_

# of Bays: \_\_\_\_\_

Attached \_\_\_\_\_ Detached \_\_\_\_\_

Under house \_\_\_\_\_

Bonus Room Above Garage:

\_\_\_\_\_ x \_\_\_\_\_ (size)

\_\_\_\_\_ sq ft

**3. CONTRACTOR: (copies of license & insurance required)**

Name: \_\_\_\_\_

Mailing Address: \_\_\_\_\_

Contact Phone(s): \_\_\_\_\_

**8. STRUCTURAL DETAILS: (please list all types)**

Finished Exterior \_\_\_\_\_ Finished Flooring \_\_\_\_\_

# of Bedrooms \_\_\_\_\_ # of Bathrooms \_\_\_\_\_

Fireplace type (if any ex: wood burning/gas) \_\_\_\_\_

Type of Heat \_\_\_\_\_ Air Conditioning \_\_\_\_\_

**4. ARCHITECT/ENGINEER: (if any)**

Name: \_\_\_\_\_

Address: \_\_\_\_\_

Phone: \_\_\_\_\_

**9. TYPE OF WORK:**

(permit fees will be valid only for the boxes checked)

\_\_\_\_\_ Foundation \_\_\_\_\_ Plumbing

\_\_\_\_\_ Structural \_\_\_\_\_ Heating & Ventilation

\_\_\_\_\_ Electrical \_\_\_\_\_ Propane

**PLEASE COMPLETE THE FOLLOWING ON THE GRAPH PROVIDED:**

**\*\* To be done in addition to submission of site plan \*\***

1. Approximate outline of proposed structure with dimensions
2. Distance from proposed structure to property lines; if the lot is irregularly shaped, indicate approximate shape
3. Abutting streets
4. Location of well or water line
5. Driveway
6. Curtain drains, if any
7. Distance from proposed structure to septic system including location of leach field
8. Layout of leaching system
9. Any outstanding topographical features such as ledge, outcroppings, ponds, swamps, streams, gullies, steep slopes, large trees etc.

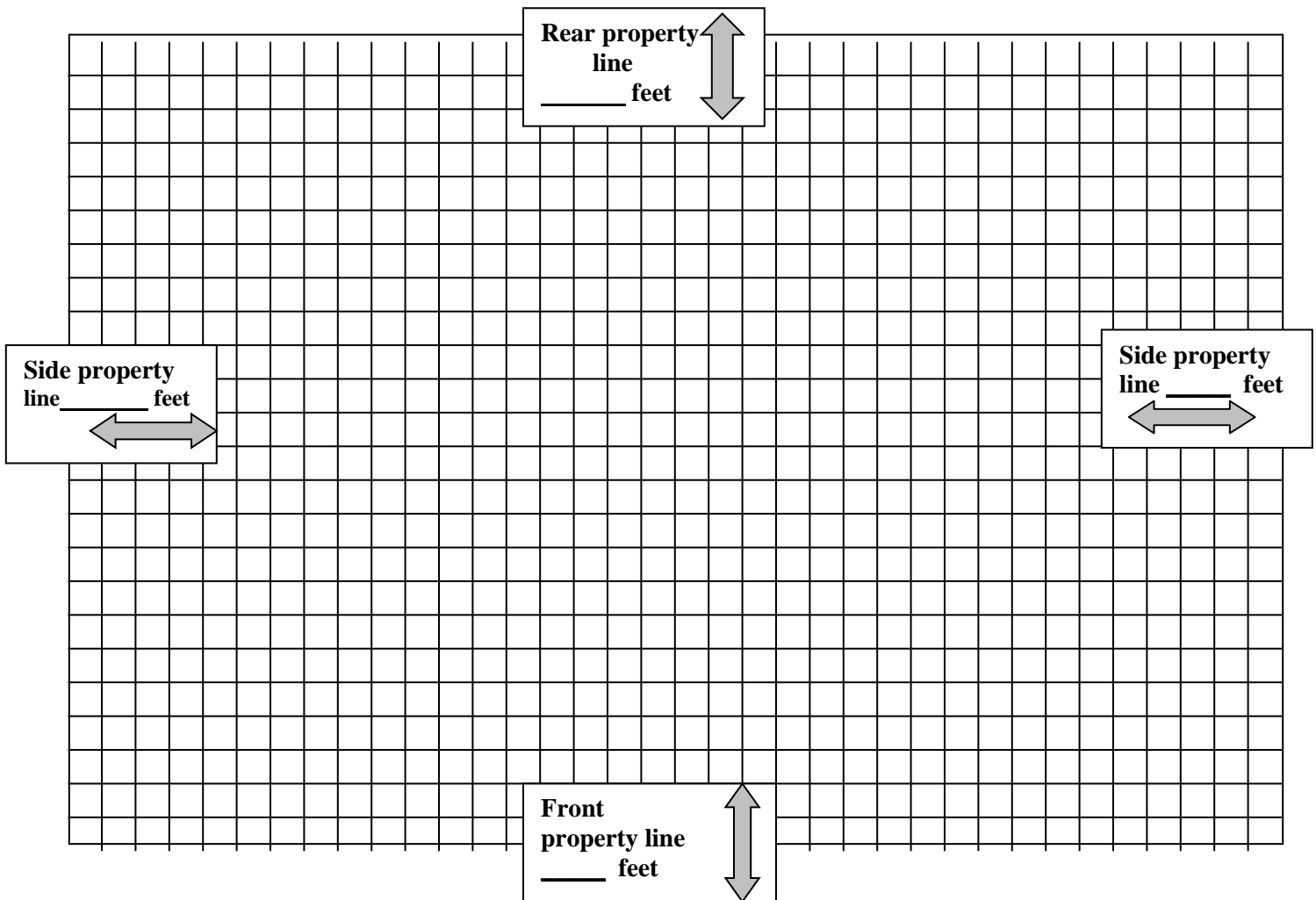

Indicate name of road structure faces \_\_\_\_\_

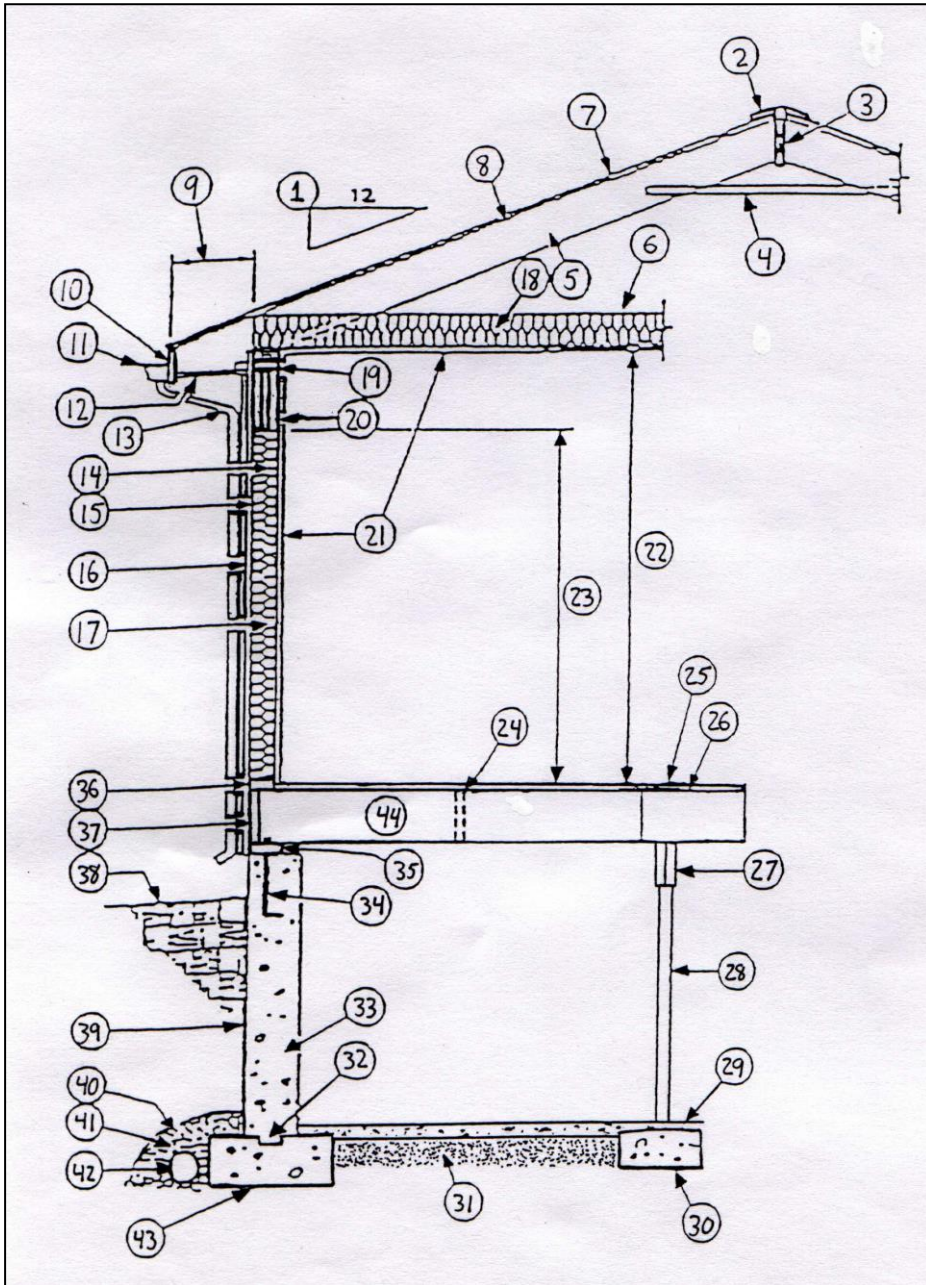

- 1 Pitch Triangle
- 2 Ridge Cap / Vent
- 3 Ridge Board
- 4 Collar Tie
- 5 Rafter
- 6 Ceiling Joist
- 7 Roofing
- 8 Sheathing
- 9 Overhang or Tail
- 10 Fascia
- 11 Gutter
- 12 Soffit / Vent
- 13 Leader or Downspout
- 14 Stud
- 15 Sheathing
- 16 Siding
- 17 Insulation (Walls)
- 18 Insulation (Ceiling)
- 19 Plate
- 20 Header
- 21 Gypsum Board or Plaster
- 22 Finish Height
- 23 Window & Door Height
- 24 Bridging
- 25 Finish Floor
- 26 Sub Floor
- 27 Carrying Beam /
- 28 Microlam
- 29 Column
- 30 Concrete Floor
- 31 Column Footing
- 32 Gravel Depth
- 33 Footing Key
- 34 Foundation Wall
- 35 Anchor Bolt
- 36 Sill
- 37 Shoe or Sole
- 38 Perimeter Box
- 39 Grade
- 40 Waterproofing
- 41 Building Paper
- 42 Crushed Stone
- 43 Footing Drain
- 44 Footing
- 45 Floor Joist

Depth of Footing

Size of Bedroom Windows

Type of Glass

Type of Heat

Plumbing  Yes  No

Electrical  Yes  No

Septic tank  Yes  No

Well water  Yes  No

City water  Yes  No

Sewer  Yes  No

Ground Fault Interrupter

Smoke Detector

Hurricane clips

Fire stopping

I hereby certify that I am the owner or authorized agent of the owner of the property herein described. I will conform to the applicable requirements of the Basic Building Code and Public Health Code of the State of Connecticut, the Ordinances of the Town of Griswold and to any requirements not specifically covered by these Codes and Ordinances, but deemed by the Building Official and/or Town Engineer to be essential for structural, fire, or sanitary protection. It is understood that neither the Town of Griswold nor any authorized agent assumes any responsibility for construction or maintenance of any facility built under permit for which this application is made.

I grant permission to the Building Official and Assessor to enter the property to do required inspections. I hereby certify that the proposed work will conform to the Basic Building code and all other Codes as adopted by the State of Connecticut. I understand that under the State of Connecticut IRC Section 110 / IBC Section 111

**A CERTIFICATE OF OCCUPANCY/COMPLIANCE IS REQUIRED FOR ALL PERMITS ISSUED.**

Applicants Signature \_\_\_\_\_

(If Agent/Contractor check here) \_\_\_\_\_

Date of Application: \_\_\_\_\_

Estimated Cost of Proposed Structure: \$ \_\_\_\_\_

Estimated Cost of Electric: + \$ \_\_\_\_\_

Estimated Cost of Plumbing: + \$ \_\_\_\_\_

Estimated Cost of Heating: + \$ \_\_\_\_\_

TOTAL ESTIMATED COST: = \$ \_\_\_\_\_

("Estimated Cost" should include foundation, shell/structure, interior finishing, etc. All electric, plumbing and heating costs are to be listed separately however if estimates are not known at this time they may be paid for when application for each is made at a later date – be sure not to include septic, well, excavation, gravel, land, etc.)

**BELOW THIS LINE IS FOR OFFICE USE ONLY!**

Date Application Received: \_\_\_\_\_

Date Paid: \_\_\_\_\_

Building Permit Fee: \$ \_\_\_\_\_

Permit #: \_\_\_\_\_

CT Educational Fee: \$ \_\_\_\_\_

Cash: \_\_\_\_\_

Zoning Fee: \$ \_\_\_\_\_

Check #: \_\_\_\_\_

Certificate of Occupancy Fee: \$ \_\_\_\_\_

Initial Receipt of Application: \_\_\_\_\_

Violation Fines: \$ \_\_\_\_\_

*(authorized agent initials)*

**TOTAL FEE DUE: \$ \_\_\_\_\_**

RES Check: \_\_\_\_\_

Assessors Card: \_\_\_\_\_

Contractors License/Insurance: \_\_\_\_\_

Tax Form: \_\_\_\_\_

Building Plans: \_\_\_\_\_

Wetlands/Zoning Approvals: \_\_\_\_\_

Driveway Bond: \_\_\_\_\_

Site Plan: \_\_\_\_\_

Uncas Health Dept Approval: \_\_\_\_\_

**NOTES:** \_\_\_\_\_

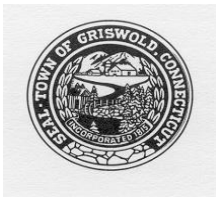

# Town of Griswold

Building Department

28 Main Street

Jewett City, CT 06351

Phone: (860) 376-7060 x.2110 Fax (860) 376-3789



## **ATTENTION:**

**This form must be signed off by the Tax Collectors Office prior to applying for all building permits!**

Pusuant to PA95-320, an act concerning approval of building applications for property in which taxes are due, the Code of the Town of Griswold Chapter 143, Article I, requires:  
“a statement in writing from the office of the Tax Collector of the Town of Griswold that there are no delinquent taxes due for the property for which an application is made, or provides a statement in writing from the office of the Tax Collector that the owner of the property for which an application is made has entered into a payment program approved by the Tax Collector to pay off any delinquent taxes which may be due”.

*Date:* \_\_\_\_\_

*Applicants Name:* \_\_\_\_\_

*Property Owners Name:* \_\_\_\_\_

*Street Address:* \_\_\_\_\_

BELOW THIS LINE IS FOR OFFICE USE ONLY:

Tax Status :

( ) *Paid to date*

( ) *Delinquent*      ( ) *Payment program approved*

*Tax status verified:* \_\_\_\_\_

Tax Collector

/

Assistant Tax Collector